

PROPOSED PROJECT AT MOUZA-TALJULI, J.L. NO-239, R.S. PLOT NO-269(P), & 270(P), L.R. PLOT NO-487,490,491 & 492, UNDER KHARAGPUR MUNICIPALITY, PS-KHARAGPUR MUNICIPALITY, DISTRICT-PASCHIM MEDINIPUR

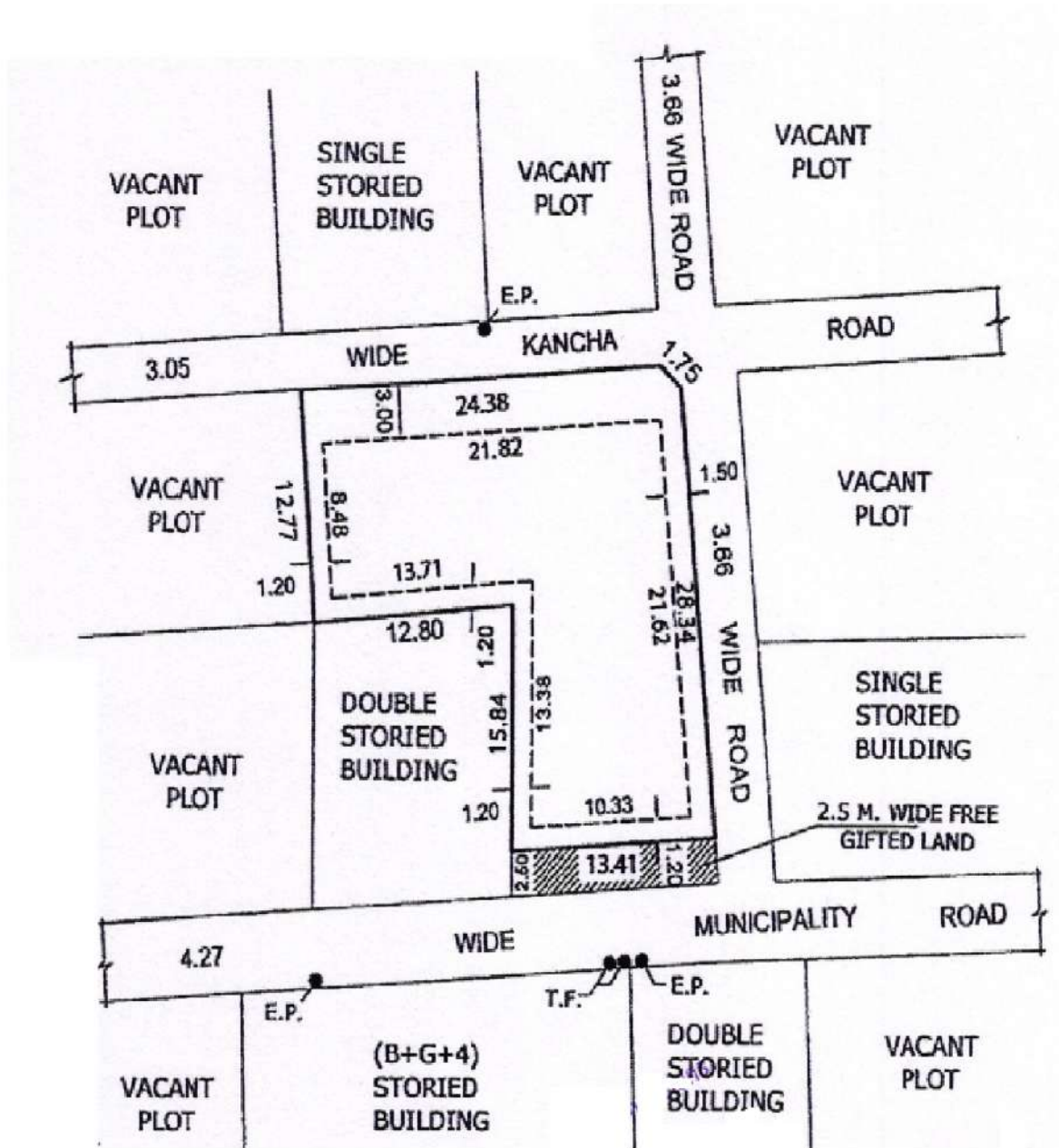

LATITUDE : 22.357240
LONGITUDE : 87.249791

For ANJAN GROUP

PARTNER

SIGNATURE OF OWNER